



# GUMT SERIES DESIGNED FOR HAZARDOUS AREAS

ELECTROSTATIC DISCHARGE SYSTEM FOR ANY TANKER OPERATING IN AN EXPLOSIVE ENVIRONMENT

## First-class raw materials

Manufactured with top-quality materials, GUMT Series is available in copper-free aluminium

## Applications

GUMT Series is a control and discharge system for electrostatic charges: the solution to control safely the discharge of static charges by driving it through a dedicated and safe path. Suitable for a wide range of applications, GUMT Series can be used for:

- Rail Tankers
- Road Tankers
- Aircraft Tankers
- Additional movable tankers of dangerous materials (i.e. gasoline and diesel)

Available with one or two clamps.

## Optional accessories

- Cable reel
- Drain/breather valve
- Internal anticondensation painting
- Stainless steel certificate label



[technor.com](http://technor.com)



## FEATURES & BENEFITS:

**ATEX, IECEx, EAC certified**

**Suitable for Zone 1, 2, 21, 22**

**Ingress Protection: IP65 / IP66**

**Ambient temp. range: -20°C to +55°C**

**Complete with arrest/consensus optical warning and changeover contact free from the output voltage.**

**Ready for one/two double circuit clamps  
ISEO-2: reliable, robust and easy to use**

 **TECHNOR**  
**ITALSMEA**

A COMPANY OF MARECHAL ELECTRIC

# EX-CERTIFIED SOLUTION

## GUMT IS MADE OF:

**Enclosure - GUB/QL Series**

**Execution:** II 2 G Ex d IIC T5 Gb  
II 2 D Ex tb IIIC T100°C Db

Degree of protection: IP66

## GUMT CAN BE PROVIDED WITH:

**Clamp - ISE0-2**

**Execution:** II 2 G Ex d IIC T6 Gb  
II 2 D Ex tb IIIC T85°C Db

Degree of protection: IP65



## DIMENSIONS & AVAILABLE VERSIONS

### Dimensional drawings

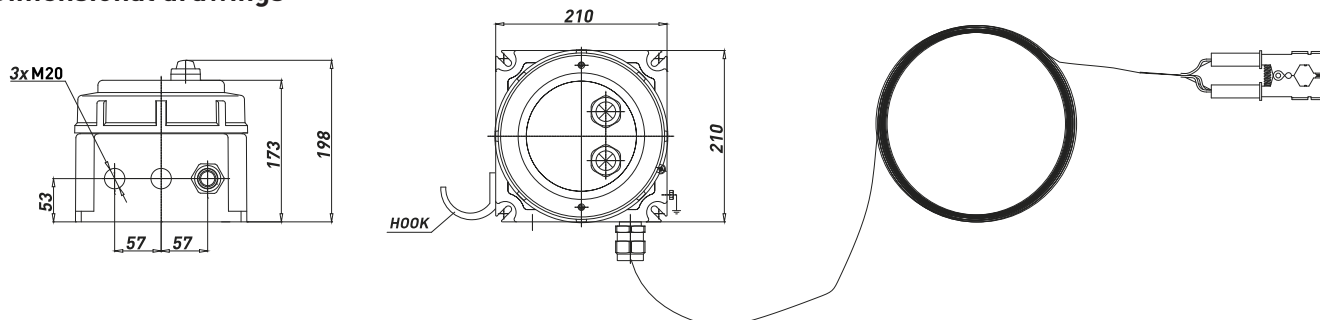

### Available versions

Type	Code	Voltage	Available Certificates
GUMT-325	B013094010014	110-220 VAC	ATEX / IECEX / EAC
GUMT-325	B013094010015	24 VDC	ATEX / IECEX / EAC
GUMT-325 + 1 CLAMP ISE0-2	B013094010013	110-220 VAC	ATEX
GUMT-325 + 1 CLAMP ISE0-2	B013094010012	24 VDC	ATEX
GUMT-325 + 2 CLAMP ISE0-2	B013094010011	110-220 VAC	ATEX

### Additional products



GUB Series



GUB/QL Series



GUB/EMH Series