

GAS GROUP IIB + H₂

EJB.. Series – Galvanized carbon steel



EJB.. series enclosures offers Ex d IIB or IIB+H2 mode of protection. They are suitable for hazardous areas of industrial plants for indoor and outdoor applications. They can be equipped with following components:

- Push buttons and mechanical operators PL.. Series;
- Rotating switches PSRC Series;
- Signalling lamps PL.. Series;
- Potentiometers;
- Rotating handles SRC-1 or SRC-10;
- Measurement instruments;
- Electric and electronic equipment;
- Windows made of tempered glass.

They can be used in different applications such as push button stations, instrument housing, lighting distribution panels, power distribution panels, heat tracing panels, motor protection, etc.

TECHNICAL FEATURES

Material	Galvanized carbon steel
IP rating	IP65, IP66, IP67 with flanged joint coated with silicone grease
Ambient temperature range	-50 °C up to +60 °C
Approvals	Certified INERIS 00ATEX0021X TR CU IECEX INE 10.0015X INMETRO PESO
Marking	II 2 GD Ex d IIB T(**) Gb or Ex d IIB+H2 T(**) Gb Ex tb IIIC T(**) Db IP65 or 66 or 67 ** T6/T85°C, T5/T100°C, T4/T135°C, T3/T200°C II 2(1) GD Ex d [ia Ga] IIB T6 Gb or Ex d [ia Ga] IIB+H2 T6 Gb Ex tb [ia Da] IIIC T85°C Db IP65 or 66 or 67 II 2(2) GD Ex d [ib] IIB T6 Gb or Ex d [ib] IIB+H2 T6 Gb Ex tb [ib] IIIC T85°C Db IP65 or 66 or 67
Surface treatment	Hot dip galvanization
Entries	Metric pitch 1.5, ANSI B1.20.1 NPT, UNI-6125
Included accessories	AISI316 Stainless steel external screws
Standard certificate label	Made by self adhesive UV and corrosion resistant polyester, approved by certified Laboratory.
Optional accessories	Drain/breather valve Door handle External polyurethane painting cycle Internal anticondensate painting Traffolyte/Stainless steel certificate label

Dimensions EJB Galvanized carbon steel

The sides A, B & C of our EJB enclosures can be increased/decrease of 15% covering the dimensions from 298 x 238 x 175mm up to 950 x 690 x 440mm

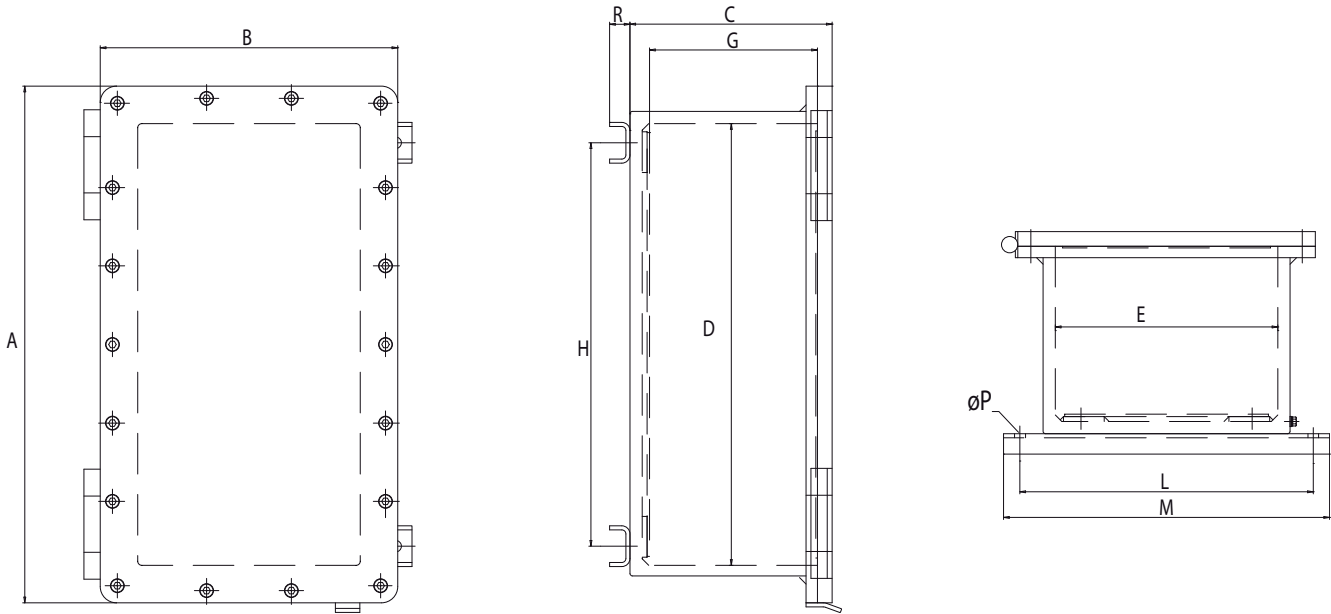

EJB.. Series enclosures c/w internal mounting plate, mounting brackets, hinges – Galvanized carbon steel

TYPE	DIMENSIONS [mm]											WEIGHT [Kg]	COVER ENTRIES	INT. MOUNTING PLATE
	A	B	C	D	E	G	H	L	M	ØP	R			
EJB-2	298	238	175	238	178	136	205	250	280	10	20	35	12	160 X 220
EJB-3	412	238	175	350	176	136	330	250	280	10	20	45	18	155 X 330
EJB-4	418	302	175	345	230	136	300	305	340	12	20	55	20	210 X 325
EJB-5	480	300	222	405	225	183	350	295	330	12	20	70	22	200 X 385
EJB-6	483	408	229	399	324	166	355	410	450	14	25	93	28	300 X 380
EJB-8	634	365	248	542	273	204	495	360	400	14	25	114	36	250 X 520
EJB-9	535	468	248	443	376	204	400	460	500	14	25	118	34	350 X 420
EJB-11	596	505	247	496	405	203	445	490	530	14	25	139	44	380 X 470
EJB-12	805	455	300	705	355	252	640	440	480	16	30	181	54	325 X 675
EJB-13	832	608	300	732	508	250	667	605	650	18	30	235	76	463 X 683
EJB-13A	832	608	390	732	508	342	667	605	650	18	30	262	76	463 X 683

Maximum number of entries on sides A/B

TYPE	EJB-2	EJB-3	EJB-3A	EJB-4	EJB-5	EJB-6	EJB-8	EJB-9	EJB-10	EJB-11	EJB-12	EJB-13	EJB-13A
M20/1/2"	9/7	14/7	14/7	14/9	27/13	24/18	35/16	27/24	57/21	32/27	61/28	48/32	81/54
M25/3/4"	9/5	7/3	7/3	7/4	14/7	14/10	29/13	24/18	46/18	21/27	40/18	27/18	54/36
M32/1"	4/3	6/3	6/3	6/4	12/5	12/9	18/8	12/10	29/10	14/12	32/16	23/16	35/24
M50/1" 1/2	3/2	4/2	4/2	4/3	5/2	5/4	7/3	9/9	14/5	6/5	16/7	9/6	18/10
M63/2"	2/1	3/1	3/1	3/2	4/2	4/3	6/2	4/4	12/4	5/4	12/5	8/5	14/9
M75/2" 1/2	-	-	-	-	3/1	3/2	4/2	3/3	5/2	4/3	6/3	6/4	6/4
M80/3"	-	-	-	-	2/1	2/2	3/1	2/2	4/1	3/2	4/2	5/3	5/3